

Headline:	New Ward Design for Jurong General Hospital		
Media Title:	93.8Live Online		
Date:	2010-02-12	Section:	Singapore
Page No:	N/A	Size:	N/A
Description:	The upcoming Jurong General Hospital will have a better ward layout designed to promote healing. All wards at the hospital will feature a fan-shaped layout. This would allow each bed in the ward to be positioned next to a window.		

New Ward Design for Jurong General Hospital

11 Feb 2010

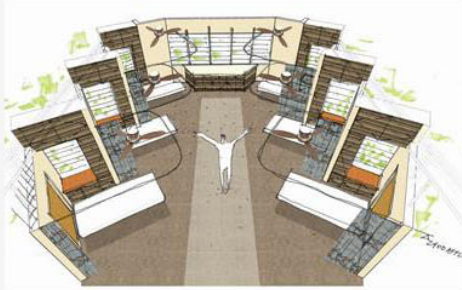

The upcoming Jurong General Hospital will have a better ward layout designed to promote healing.

The Newsdesk finds out more about the hospital's "window for every patient" ward design concept.

All wards at the hospital will feature a fan-shaped layout.

This would allow each bed in the ward to be positioned next to a window.

The hospital said the design is expected to significantly improve ventilation in the non-airconditioned B2 and C class wards as well as maximise natural light.

This would not only enhance patient comfort and recovery.

It would also allow for improved infection control and a more spacious working area for hospital staff.

C class patients will also have greater privacy with a higher partition between each bed.

The hospital's Chief Executive Officer is Foo Hee Jung.

"Actually the idea around this about introducing a window next to every bed is from the airline industry virgin airlines for example they actually slant their seats so they can afford some level of privacy and every one will be close to a window seat."

Mr Foo said 80 per cent of the beds in the hospital will be in the C and B2 class wards.

Meanwhile, the hospital is tying up with the Employment and Employability Institute in its first recruitment drive.

It hopes to hire 60 patient service associates, patient information assistants and other patient support positions through this initial round of recruitment.

The 700-bed hospital is looking to hire 300 more staff members by July.

The hospital hopes to have a staff strength of 3,000 by the time it opens in 2014.

The hospital will provide acute inpatient and outpatient care.

Along with it, a 200-bed community hospital will be built to offer sub-acute and rehabilitative patient care.

This report was filed by Wang Eng Eng.

